

THESE DRAWINGS AND SPECIFICATIONS ARE THE PROPERTY OF JBL INCORPORATED. THEY ARE ISSUED IN STRICT CONFIDENCE AND SHALL NOT BE REPRODUCED OR USED AS THE BASIS FOR MANUFACTURE OR APPARATUS WITHOUT WRITTEN PERMISSION.

ALL MATERIAL SPECIFIED ON THIS DRAWING SHALL COMPLY WITH EUROPEAN DIRECTIVE 2002/95/EC. **RoHS**

REVISIONS						
CHG	LTR	DESCRIPTION	DRAFT	D/C	DATE	APPR
38459	A	RELEASE TO MARKETING	TH		8/4/09	BW
38778	B	REV DIMENSIONING SCHEME	TH		9/8/09	BW
39049	C	REV DIMENSIONING SCHEME	YT			

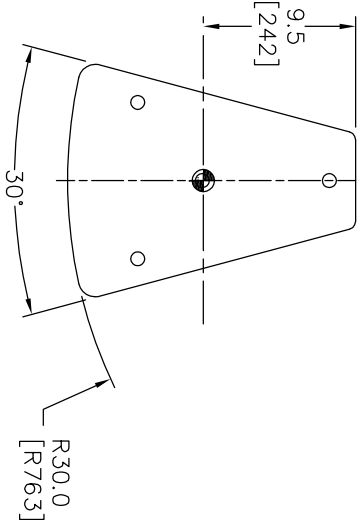

TOP

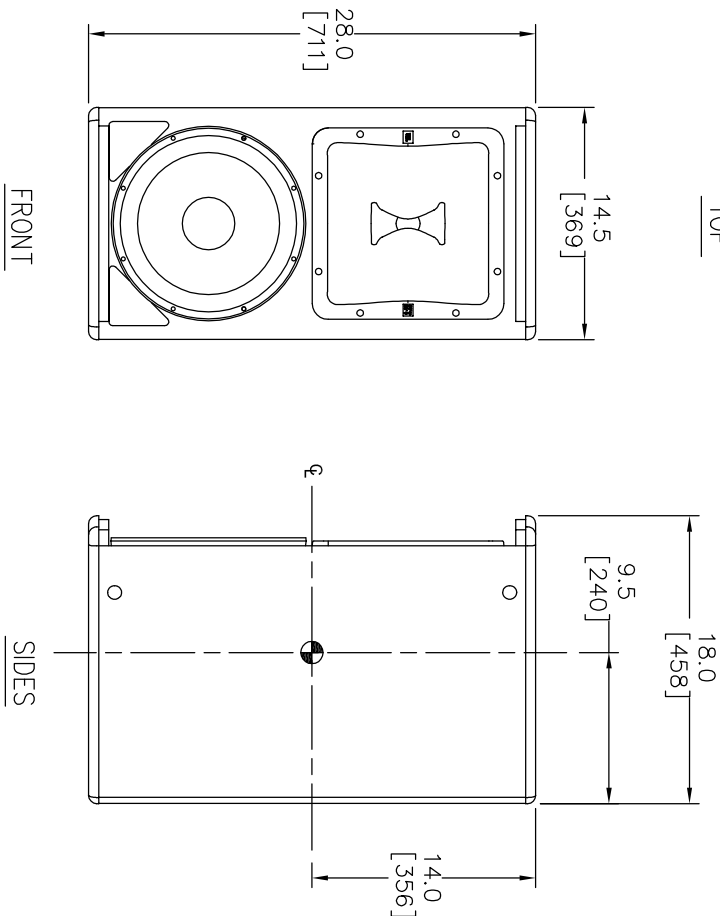

FRONT

SIDES

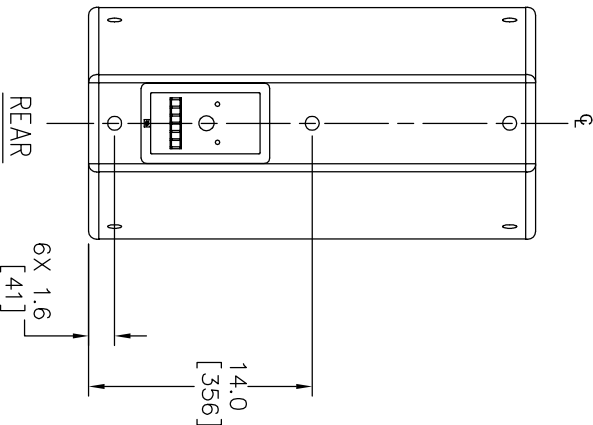

REAR

8. CENTER OF GRAVITY (CG)

7. WEIGHT: 20.2 Kg [45 LBS]

6. SUSPENSION POINTS: M10 THREADED SUSPENSION POINTS, 4X TOP, 4X BOTTOM, 2X LEFT, 2X RIGHT, 3X REAR

5. COMPONENTS: LF – 262H–1
HF – 2408H–1

4. INPUT CONNECTORS: NEUTRIK NL4 IN PARALLEL WITH 4 POSITION TERMINAL STRIP.

3. GRILL: 14 GA. PERFORATED CRS, POWDER COATED BLACK WITH BLACK FOAM BACKING.

2. MATERIALS: 5/8 INCH BIRCH PLYWOOD.

1. FINISH: BLACK DURAFLEX
(WHITE AVAILABLE BY CUSTOM ORDER)

NOTES: (UNLESS OTHERWISE SPECIFIED)

TOLERANCES (UNLESS OTHERWISE SPECIFIED)	
X.XX	± .063 INCH
X.X	± .125 INCH
ANGULAR TOLERANCE OF 0±30°	
FRACTIONAL DIMENSIONS ± 1/32	
• DIMENSIONS ARE INCHES	
• ALL DIMENSIONS ARE FINISHED DIMENSIONS	
• DO NOT SCALE DRAWING	

TITLE	JBL PROFESSIONAL A Harman International Company Northridge, California 91329 U.S.A.
-------	---

CUSTOMER DRAWING: AM5212/XX

SIZE	DRAWING NO.	REV
A	443935	C

SCALE	NTS	SHEET	1	OF	1
-------	-----	-------	---	----	---